

*Championship Golf  
within your Reach!*



**Centennial Valley  
Golf & Country Club**

**An Affordable Country Club with a  
Challenging 18-Hole Championship Golf Course**

*Gold Card*

**GOLF MEMBERSHIP**

For access to all Golf Courses  
Professionally managed by Lindsey Management Co., Inc.

Call or visit us today and ask about  
our **Gold Card** Golf Membership  
We are open 7 days a week!

**501.513.2522**

Michael Smith  
General Manager  
1600 Centennial Club Drive  
Conway, AR 72034  
Fax: 501.513.2524

Email: [proshop@centennialvalleygolfac.com](mailto:proshop@centennialvalleygolfac.com)  
**[www.centennialvalleygolfac.com](http://www.centennialvalleygolfac.com)**

Also visit us at [www.LindseyManagement.com](http://www.LindseyManagement.com)  
To see all courses professionally managed by Lindsey Management Co., Inc.

# Club Features

Located in the up-scale Centennial Valley development of west Conway, **Centennial Valley Golf & Country Club** has something for everyone.

- 18-Hole Championship Course designed by Lyndy Lindsey with Champion Bermuda Grass greens and Bermuda fairways, tees and roughs
- Five sets of tee boxes offering challenge and pleasure to golfers of all ability levels
- Driving range, chipping area, putting green and short game play area
- Two-story Clubhouse filled with fabulous amenities designed for your lifestyle
  - The 19th Hole - a full-service restaurant that provides casual dining & year round social events overlooking the 18th hole
  - Gallery lounge
  - Full service Golf Shop
  - Kids lounge
- Resort style pool facility offers three swimming pools; junior Olympic pool, sports pool and covered wading pool & Gazebo
- Centennial Fitness Center
  - State-of-the-art cardio equipment
  - Circuit training
  - Aerobic programming
  - Free weight area
  - Saunas, showers and lockers in both men's & women's locker rooms
  - Men's Golf Association
  - Women's Golf Association
  - Junior Programming
  - Fitness Programming
- Centennial Center - a convenient and elegant setting outfitted with state-of-the-art audio/visual equipment and is versatile enough to host almost any reception, banquet, special event or conference.



## Championship Golf

# Membership Options



Memberships include full access privileges for year-round golf and all other club amenities. Memberships consist of the applying member, spouse, and all unmarried, dependent children under the age of 23, living at home.

## Membership Benefits:

- UNLIMITED GOLF with No Green Fees
- Unlimited use of the Junior Olympic Swimming Pool, Sports Pool and covered Wading Pool and Gazebo Event Area.
- Unlimited use of the Fitness Center and Tennis Court
- Unlimited use of Practice Facilities, Short Game Area, Putting Green and Chipping Green
- The 19th Hole Bar & Grill
- Meeting Rooms and Conference Center Available
- Includes a **Gold Card** for Complimentary Golf Privileges at all Golf Courses managed by Lindsey Management Co., Inc.
- USGA Ghin Service, Men's and Women's Golf Associations, PGA Jr. League and Clinics
- Children 17 and under may join and participate in Junior Golf Clinics and programs
- Class A PGA Professional on staff

### **Full Membership Package - Dues.....\$265/mo\***

With a 12-month contract and preauthorization draft.  
Initiation fee: \$500

### **Corporate Membership Package - Dues.....\$265/mo\***

Full privileges for individual officers or staff of a Company or Corporation.  
Membership is assigned to an individual, who belongs to the Company or Corporation, and is transferable.  
Membership for applicant, spouse and all unmarried, dependent children under the age of 23, living at home.  
Initiation fee: \$500 for first member; \$150 for each additional member

### **Junior Legacy Membership Package - Dues.....\$180/mo\***

Members 34 and under. Upon reaching the age of 35, will assume Full Membership monthly dues.  
Full privileges for applicant, spouse and all unmarried, dependent children under the age of 23, living at home.  
Initiation fee: \$150

### **Senior Membership Package - Dues.....\$265/mo\***

Members 55 and over.  
Full privileges for applicant, spouse and all unmarried, dependent children under the age of 23, living at home.  
Initiation fee: \$150

# Social Membership

### **Social Membership Package - Dues.....\$150/yr\***

Social membership offers dining privileges at the The 19th Hole  
Dining only privileges for applicant, spouse and all unmarried, dependent children under the age of 23 living at home.

Within Your Reach

Effective 3.1.22 | \*Dues subject to sales tax



For a relaxing round of golf, the **Centennial Valley Golf Course** appeals to players of all skill levels. Five sets of tees, large Champion Bermuda Grass greens and wide open fairways make this course an enjoyable and challenging experience for everyone. The practice facilities include a driving range, chipping area, putting green and short game/bunker play area.

**Centennial Valley Golf & Country Club** prides itself on offering programs and events for every member of the family. We strive to offer a relaxed family atmosphere for our members and guests at an affordable price. We invite you to come and join us in our country in the city environment, and you will see what makes Centennial "The best Country Club experience in Conway!"

Tees	Total Yardage	Course Rating/Slope
Black	6957	72.5/131
Blue	6529	72.3/128
White	6021	70.0/122
Gold	5096	64.9/112
Red	4529	66.5/117



Hole	Par	Yards	Legend
1	4	394	Great starting hole that provides an opportunity for success or emotional instability. Players need a well placed drive down the left on this straight away hole. Water right on drive and second make the left look good. Making par is a good start to your round.
2	3	200	A tough hole for the second of the day. A forced carry over water and a deep left bunker make the club choice as important and the shot itself.
3	4	364	The first good chance for a birdie starts here on this short par four. Deep bunkers front the elevated green with shallow depth. Hitting a good short iron second is the key here.
4	3	203	This second par 3 on the front looks easy compared to the first one but, it is not. A large bunker defends the middle and right side of this kidney shaped green.
5	4	433	A mid length par 4 which demands a good drive off the tee on this straight hole with trees bordering both sides. A front to right side bunker protects the entire right side. Therefore, take plenty of club for your second due to the large and deep green.
6	4	425	Par or better is a great score on the hardest hole on the front side. A drive down the left side will set up the second shot to a green that slopes hard from right to left. Staying left of the hole will make putting a little easier.
7	5	540	A very reachable par five that doglegs left off the tee to a wide landing area. The second shot is either a precise layup or a long approach to a elevated green with water guarding the front right.
8	4	409	Things are narrow on this shorter par 4 making the tee shot very demanding. A creek crosses the fairway and meanders the length of the hole protecting the left side. Green slopes sharply from back to front making the putting more difficult.
9	5	534	Layup or try and go over the water or creek on your tee shot is the decision you face here. Hard to reach on your second if you play conservative from the tee, birdie still in play though.
<b>Out</b>	<b>36</b>	<b>3502</b>	
10	5	493	May be the hole you have been looking for. This very reachable par 5 has little room on the drive while the second shot into the green is bordered by a pond just a few feet to the right of the green. Chance to get an eagle or birdie to start the back.
11	4	397	Good luck here on this forced carry over two bodies of water to a narrow cross fairway protected by three large bunkers to the right of the fairway and water all the way to the green on the left. Play smart here to save your round.
12	4	456	Time to hit a big drive on the longest par 4 on the course. Straight hole that plays a little downhill making club selection on the second a bit difficult. This diagonal green is protected by a right front bunker.
13	4	376	A 90° dogleg to the right makes the proper club choice a must of the tee on this shorter par 4. Green is severe from back to front and the right bunker is close to the green. Stay below the hole on your second.
14	3	190	Nice looking hole with a tranquil pond just shy of the green. Large green surface makes this hole look easy from the tee but, a few gentle slopes make for some interesting putting.
15	5	557	Very hard to reach in two this one. A pond intersects the fairway making longer players hold back off the tee and making a very long shot over water for a chance at the green in two. Good course management hole with a good birdie chance.
16	3	206	Tough par here for most players. Medium to long par 3 that plays uphill to a green that slopes hard from back to front. Be careful here, three putts are bountiful here.
17	4	400	Here is that chance to get one back on the day. Shorter par 4 that requires an accurate drive that must avoid the water on the right side. A short iron into the green gives you a chance at birdie. Green has good slope from back to front.
18	4	380	The finish to a good test of your golfing skills. Drive down the fairway left or attempt the carry over the water on the right. A great drive sets up the hole for a final birdie chance with a short iron approach to a flat green guarded by a front bunker.
In	36	3455	
<b>Totals</b>	<b>72</b>	<b>6957</b>	

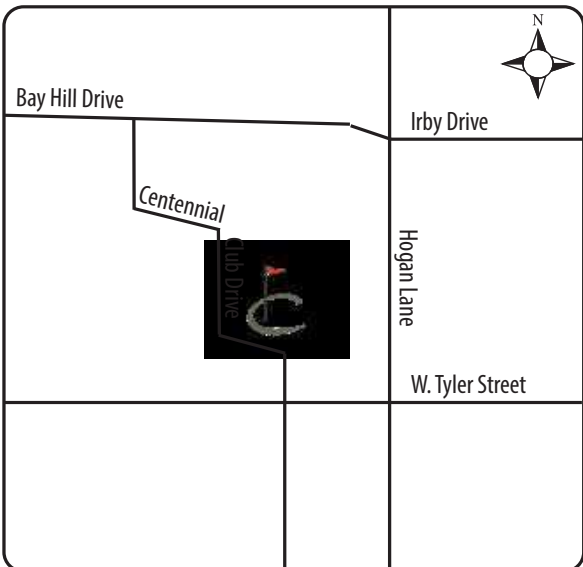
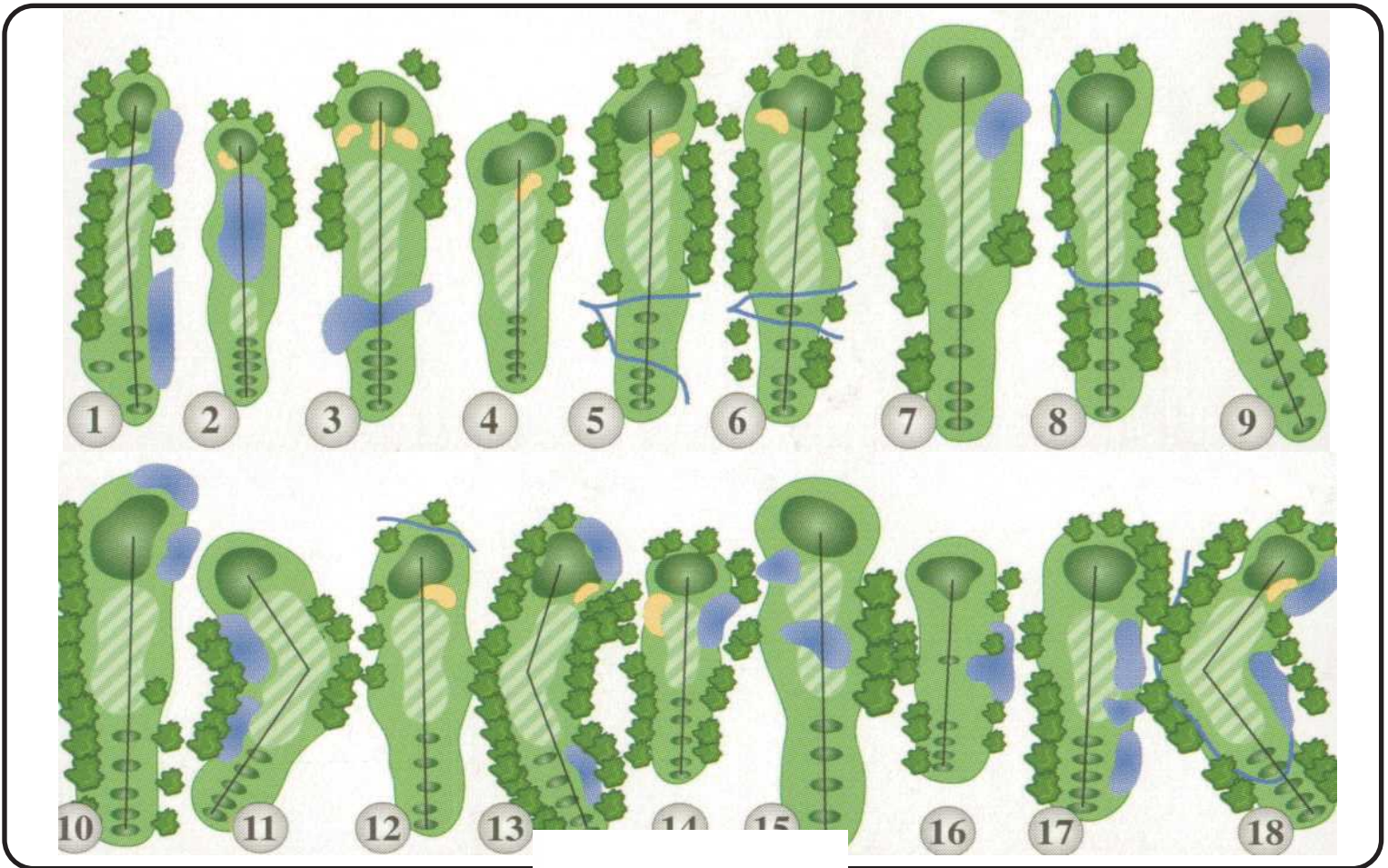

## Directions

From Exit 124 I-40: Take exit 124 toward Wooster/AR-25 North. Continue straight (0.2 mi). Turn right onto Old Morrilton Hwy/US-64 W (2.3 mi). Turn left onto Hogan Lane then right onto W Tyler Street. Take the 2nd right onto Centennial Club Drive. The Centennial Valley Golf & Country Club entrance will be on the right.

# 549

*Holes Open for Play!*

With emphasis on quality and affordability, in a country club atmosphere, the golf courses managed by Lindsey Management Co., Inc. are making a presence in the game of golf. These golf courses, designed by Lyndy Lindsey, provide a year-round pastime which may be enjoyed by those of all ages and from all walks of life.

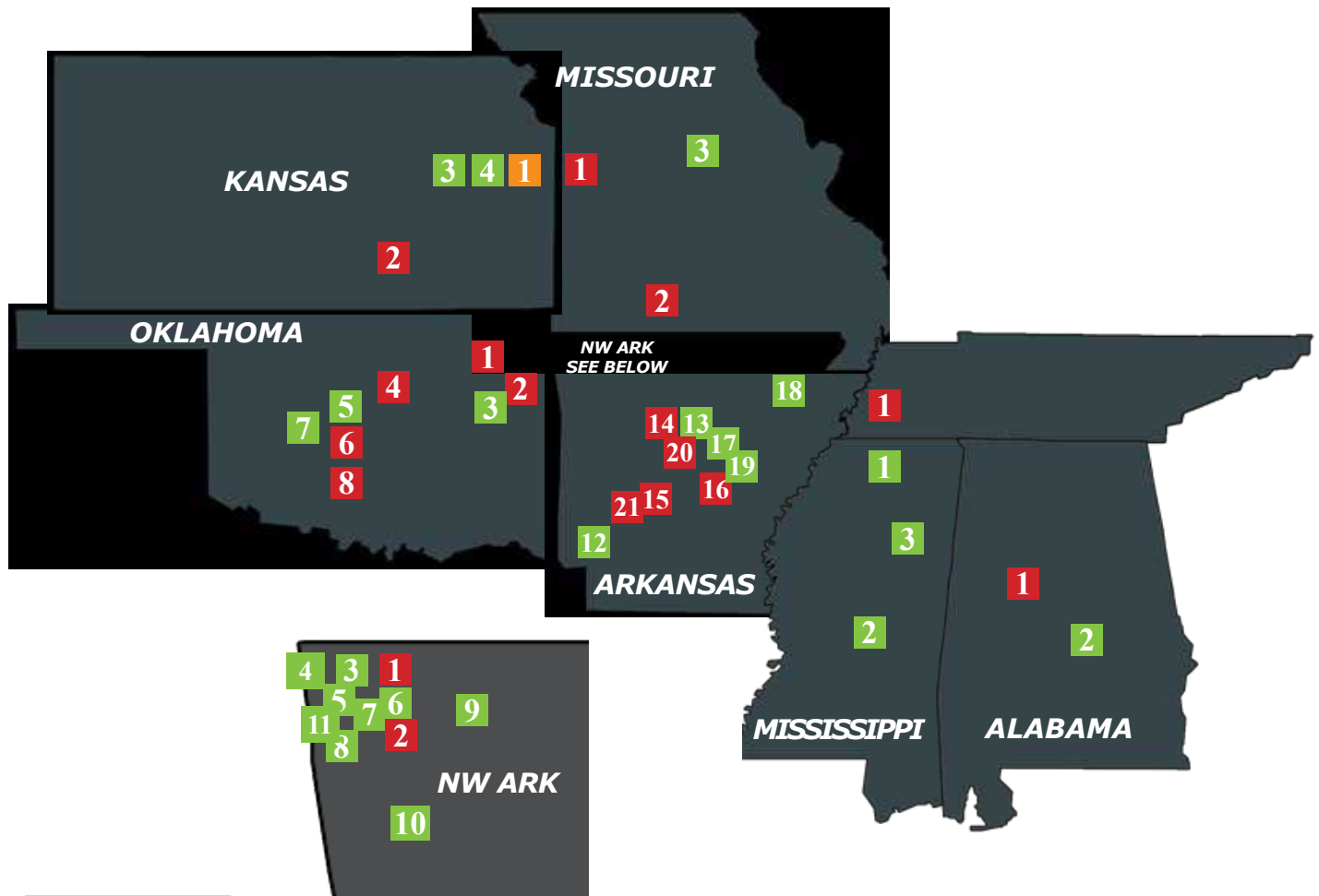

9	Holes
18	Holes
27	Holes

*We're Making a Presence in Affordable Golf - Now in 6 States and Growing!*

**Lindsey Golf**

All Golf Courses Professionally Managed by Lindsey Management Co., Inc.

# The Best Golf Opportunity Anywhere

Members of all 18 and 27 Hole Clubs with a full course membership receive a **Gold Card** and have access to all other golf courses managed by Lindsey Management Co., Inc. From 27-Hole Championship to 9-Hole Par 3s, these golf courses are designed for golfers of all ability levels.

ARKANSAS - NORTHWEST AREA					
1	18 CH	72	Lost Springs Golf & Athletic Club	3024 N. 22nd, Rogers 72756	479-631-9988
2	18 CH	71	Paradise Valley Golf & Athletic Club	3728 Old Missouri Road, Fayetteville 72703	479-521-5841
3	9 EXEC	32	The Links at Bentonville Golf & Athletic Club	2101 SE Hilton Head Dr., Bentonville 72712	479-271-0163
4	9 REG	35	The Links at Rainbow Curve Golf & Country Club	1802 SW 34th Ave., Bentonville 72712	479-657-6707
5	9 REG	35	The Greens on Blossom Way Golf & Country Club	2808 S. 28th Place, Rogers 72758	479-631-1811
6	9 Par 3	27	The Links at Lowell Golf & Athletic Club	105-A N. Dixieland Street, Lowell 72745	479-770-6066
7	9 Exec	33	The Links at Springdale Golf & Country Club	4097 Links Drive, Springdale 72762	479-750-0216
8	9 Par 3	27	Lakeside Village Golf & Athletic Club	200 Village Lake Drive, Fayetteville 72703	479-442-7748
9	9 Par 3	27	The Links at Harrison Golf & Athletic Club	1919 Club Circle, Harrison 72601	870-365-3621
10	9 Par 3	27	The Links at Fort Smith Golf & Athletic Club	5100 Zero Street, Fort Smith 72903	479-648-9691
11	9 REG	35	The Links at Fayetteville Golf & Country Club	2300 W. Player Lane, Fayetteville 72704	479-966-4330
ARKANSAS - OTHER AREAS					
12	9 EXEC	35	The Links at Texarkana Golf & Athletic Club	333 Links Drive, Texarkana 71854	870-773-6154
13	9 REG	35	The Links at Cadron Valley Golf & Country Club	3400 Irby Drive, Conway, AR 72034	501-336-0909
14	18 CH	72	Centennial Valley Golf & Country Club	1600 Centennial Club Drive, Conway 72034	501-513-2522
15	18 CH	72	Hurricane Golf & Country Club	4300 Hurricane Drive, Bryant 72022	501-847-2609
16	18 CH	72	Eagle Hill Golf & Athletic Club	3A Eagle Hill Court, Little Rock 72210	501-455-8848
17	9 Par 3	27	The Links at Sherwood Golf & Athletic Club	3434 East Kiehl, Sherwood 72120	501-833-8011
18	9 EXEC	27	The Links at Jonesboro Golf & Athletic Club	1424 Links Circle, Jonesboro 72404	870-932-2578
19	9 REG	36	The Links at the Rock Golf & Country Club	12025 Paul Eells Drive, N. Little Rock 72118	501-812-0304
20	18 CH	72	Nutters Chapel Golf & Country Club	1705 South Salem Road, Conway 72034	501-329-5867
21	18 CH	72	Longhills Golf Club	327 Highway 5 North, Benton 72019	501-316-3000
OKLAHOMA					
1	18 CH	72	Owasso Golf & Country Club	13604 E. 84th Street North, Owasso 74055	918-274-4884
2	18 CH	72	Broken Arrow Golf & Country Club	1651 E. Omaha Street, Broken Arrow 74012	918-355-0602
3	9 REG	35	The Links on Memorial Golf & Athletic Club	11500 Links Court, Bixby 74008	918-369-6035
4	18 REG	72	The Links at Stillwater Golf & Country Club	4599 N. Washington, Stillwater 74075	405-780-7167
5	9 EXEC	30	The Links at Oklahoma City Golf & Athletic Club	700 N.E. 122nd, Oklahoma City 73114	405-936-9214
6	18 CH	72	Moore Golf & Athletic Club	920 S.W. 19th Street, Moore 73160	405-790-0264
7	9 REG	35	The Links at Mustang Creek	2004 S. Mustang Road, Yukon, OK	405-577-5858
8	18 CH	71	The Links at Norman Golf & Country Club	3927 24th Ave. SE, Norman, OK 73071	405-329-6549
KANSAS					
1	27 CH	72	Shawnee Golf & Country Club	6404 Hedge Lane Terrace, Shawnee 66226	913-422-8357
2	18 CH	72	Derby Golf & Country Club	2600 Triple Creek Road, Derby 67037	316-788-3070
3	9 Par 3	27	Links at Manhattan Golf Club	500 Admiral Way, Manhattan 66502	785-539-8448
4	9 Par 3	27	Links at Kansas Golf Club	5401 Rock Chalk Drive, Lawrence 66049	785-841-3868
MISSOURI					
1	18 CH	72	Grand Summit Golf & Country Club	15101 Grand Summit Blvd., Grandview 64030	816-331-3978
2	18 CH	72	Springfield Golf & Country Club	3106 E. Valley Water Mill Rd., Springfield 65803	417-833-6821
3	9 REG	35	The Links at Columbia Golf & Country Club	5000 Clark Lane, Columbia, MO 65202	573-474-4459
TENNESSEE					
1	18 CH	72	Irene Golf & Country Club	8141 Irene Boulevard, Memphis 38125	901-752-1521
MISSISSIPPI					
1	9 REG	35	The Links at Oxford Golf & Country Club	44 PR 3151, Oxford 38655	662-234-4875
2	9 REG	35	The Links of Madison County Golf & Country Club	147 Links Dr., Bldg. 33, Canton, MS 39046	601-859-0585
3	9 REG	35	The Links at Starkville Golf & Country Club	1211 Player Lane, Starkville, MS 39759	662-323-1280
ALABAMA					
1	18 CH	71	The Links at Tuscaloosa Golf & Country Club	1800 Links Blvd. #7501, Tuscaloosa, AL 35405	205-247-9990
2	9 REG	36	The Greens at Auburn Golf & Country Club	4315 Golf Club Drive, Auburn, AL 36830	334-821-2741

# Golf Club Rules and Regulations

1. United States Golf Association Rules of Golf will govern play, except as modified by local rules, if any.
2. Appropriate attire includes shorts or pants and collared shirts.
3. Only golf shoes with soft spikes or tennis shoes may be worn on the golf course.
4. All members and guests must sign-in at the Pro Shop before beginning play.
5. All play must start at Hole No. 1 and should continue in consecutive order.
6. Tee-off is from the designated markers only.
7. Proper golf etiquette should be exercised at all times. Courtesy toward other players is required including but not limited to, no yelling or excessive noise, insuring other groups are out of range before playing, faster players should be allowed to play through, repairing all ball marks.
8. Each player must have his/her own clubs.
9. Anyone renting or operating a golf cart must be at least 16 years of age.
10. Golf carts must be kept on the cart paths at all times, unless notices are posted permitting the 90-Degree Rule (allows player to turn cart at a right angle from the cart path to proceed to ball in play).
11. Walking or bicycling is not allowed on the golf course.
12. Golfers under the age of 14 must be accompanied by an adult (experienced golfers may receive special permission to play without an adult at management's discretion.)
13. Small children accompanying golfers must remain in golf cart at all times while on the golf course.

*\*Local Course Rules- Refer to separate form available through the Pro Shop. All players must schedule tee times through Pro Shop. Please have your Membership Card available when using the facilities.*

# Gold Card Rules and Regulations

## **Restrictions Governing Play**

Play will at all times be subject to rules, regulations, hours and tournament dates set forth by the host club.

## **Tee Time Availability**

At all 18-hole Championship golf courses, tee times must be scheduled in advance of play by calling the host golf shop. Members will need to identify themselves as a **Gold Card** member and mention name of home course. Times may not be scheduled more than 24 hours in advance.

## **Credential Requirements**

Upon arrival at the host club, members should check in at the pro shop and produce the following items:

- **Gold Card** Membership Card
- Photo ID

## **Guest Policy**

Members will be allowed a maximum of three guests per visit to a host course. Guests will be charged the regular guest fee rate of the host course.

## **Payment/Charge Policy**

Cash or credit cards must be used to pay for any items purchased or used. Charging back to the home course account will be allowed only at the approval of management of the host club. Executive and Par-3 courses are not set up for charges; therefore cash or credit cards must be used at these courses.

## **Delinquent Members**

Any member on the delinquent or no-play lists at their home course will not be afforded privileges at other facilities.

## **Tournaments/Member Associations**

Membership in club organizations or participation in club affiliated tournaments will be allowed only at the home club.

Play in open or invitational tournaments will be allowed at all facilities.

## **Cart/Range Policy**

Membership in the annual range or cart program at the home course will not be honored at host courses. Fees will be charged based on the regular fee structure of the host course. Private carts will not be allowed access at host clubs.

## **Use of Other Amenities Policy**

**Gold Card** members playing golf at a host club will have use of its amenities, including the fitness center, tennis court, pool, etc.